

Historic Miramar Infrastructure Improvements, Phase IV

Miramar, Florida

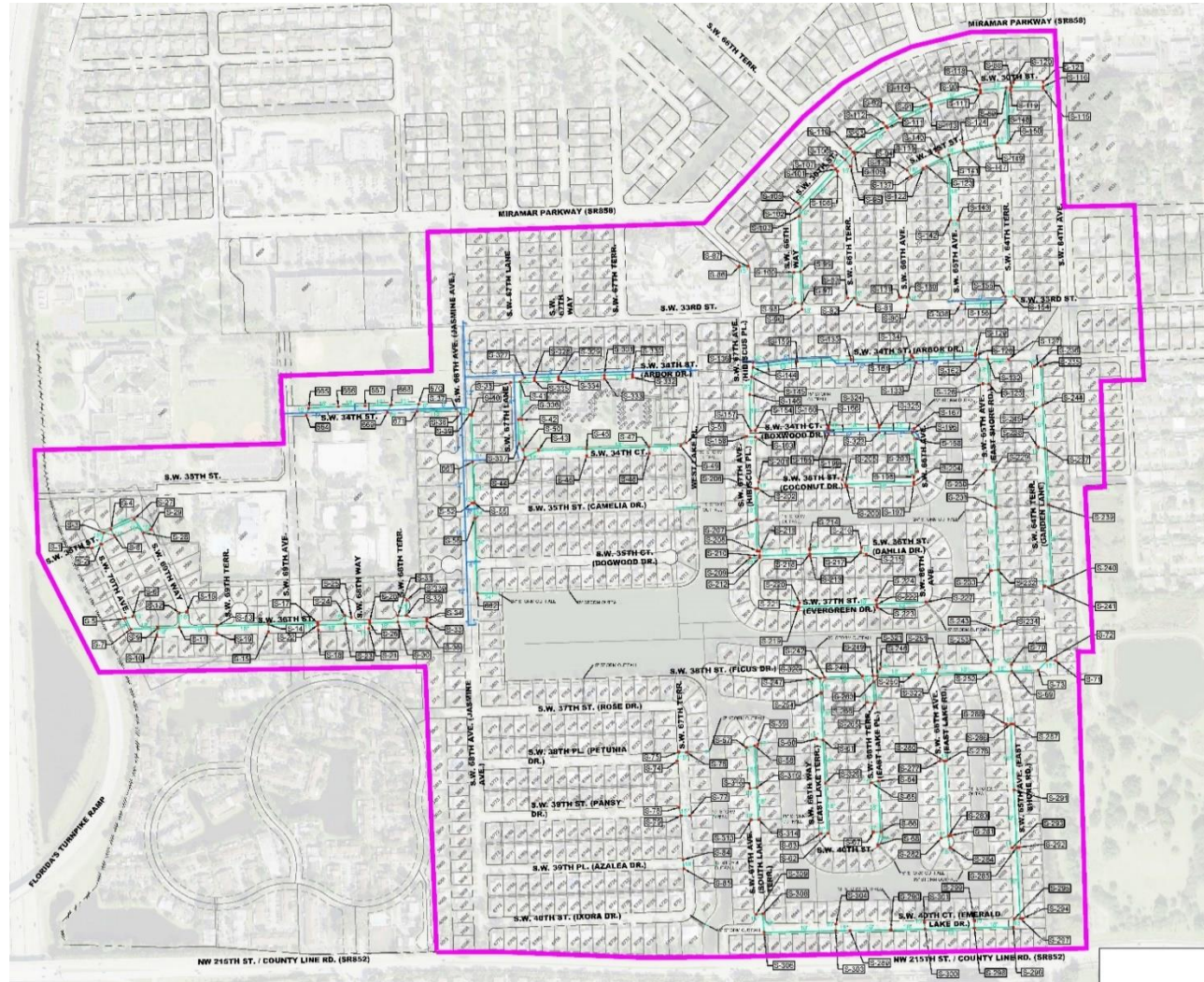



Historic Miramar Infrastructure Improvements, Phase IV

Miramar, Florida

Phase IV Limits:

The Historic Miramar Infrastructure Improvements - Phase IV is located in the general area bounded by SW 64th Avenue to the east, County Line Road to the south, Florida Turnpike to the west and Miramar Parkway to the north in the City of Miramar, Florida.



Historic Miramar Infrastructure Improvements, Phase IV

Miramar, Florida

Phase IV includes:

The scope includes swale reconstruction, installing exfiltration trench, storm sewer piping, storm structures, limited driveway apron replacement, sidewalk replacement, milling & overlay of pavement, replacement water main, pervious pavement, pavement marking, irrigation system repair, and sod restoration.

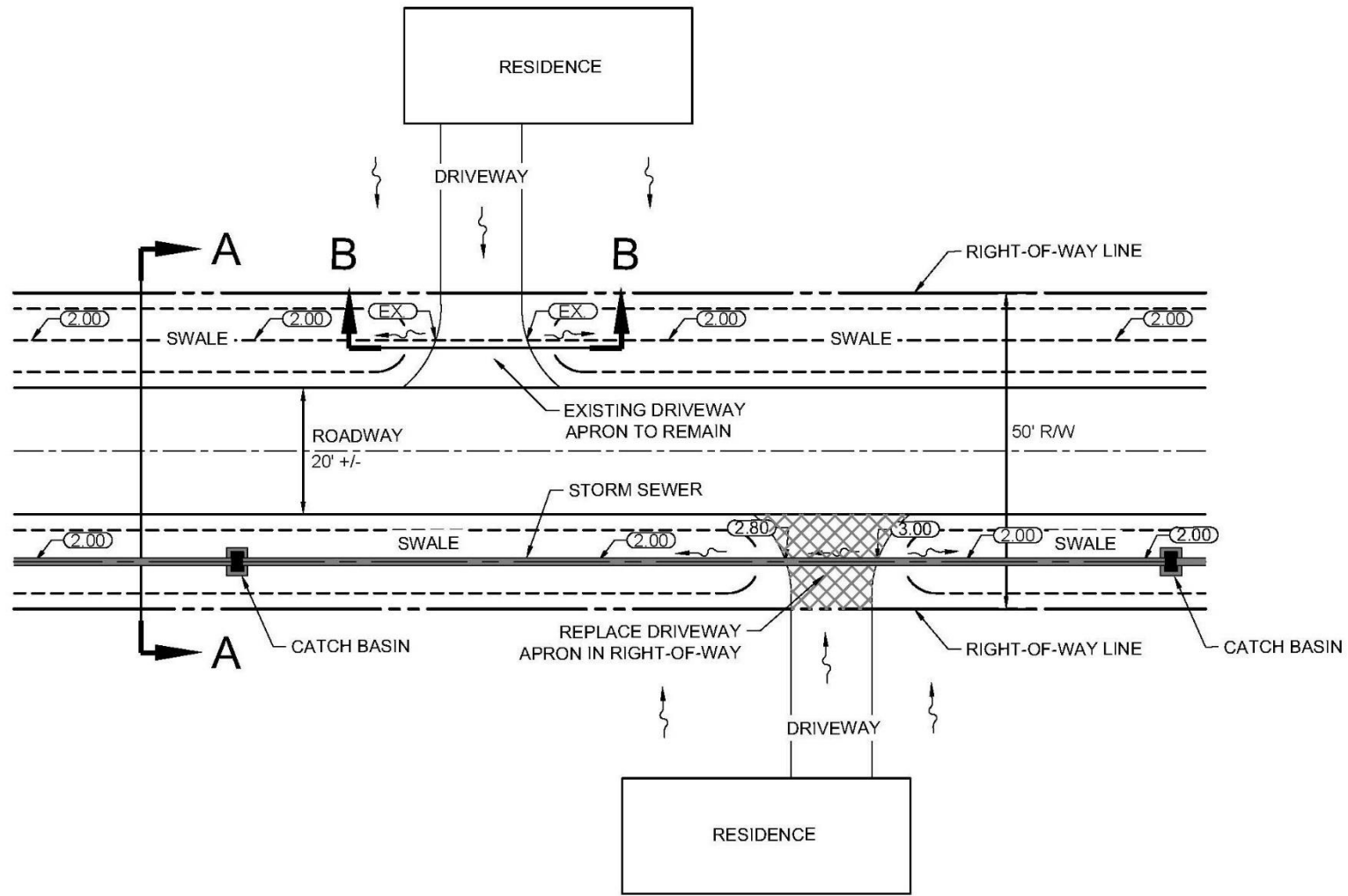

Typical Swale Regrading

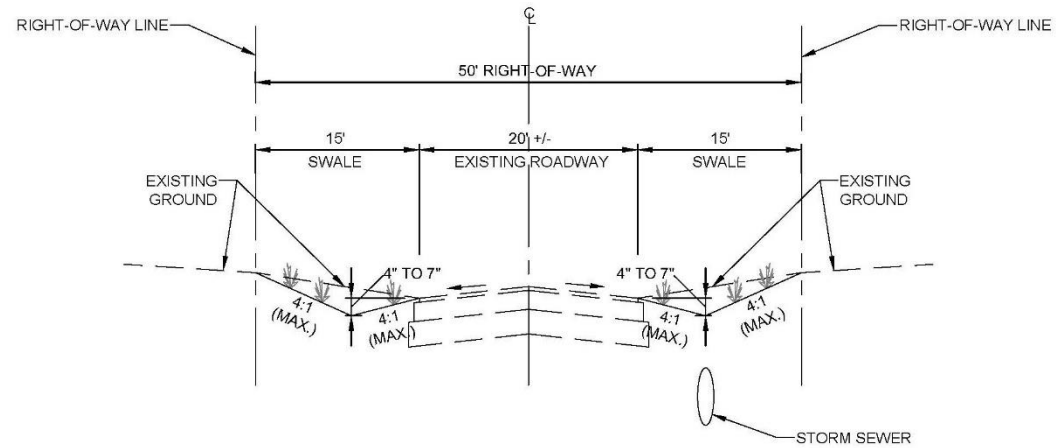

Section A - A

Regrading to Restore Swales

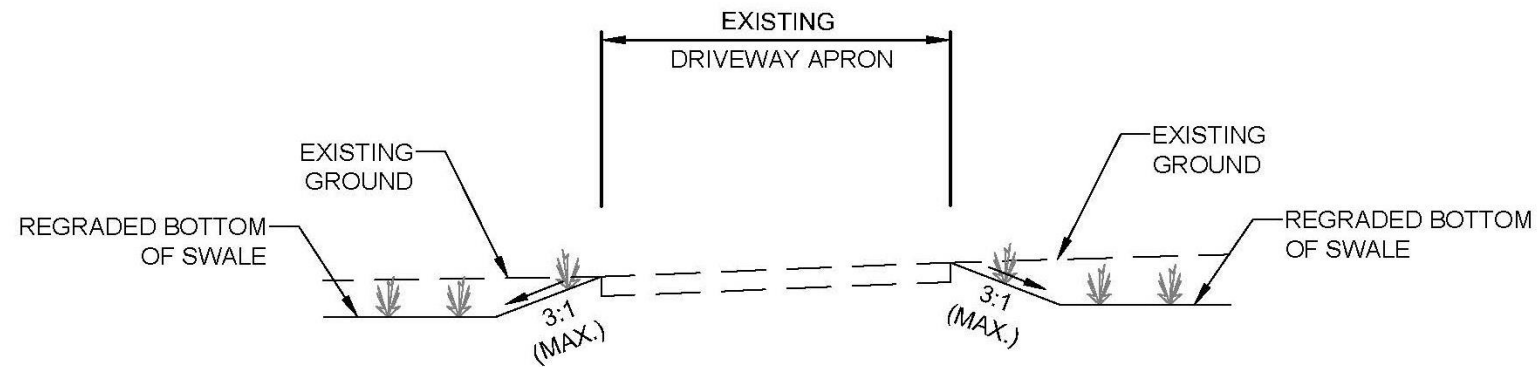

Section B - B

Typical Cross Section at Driveway Apron

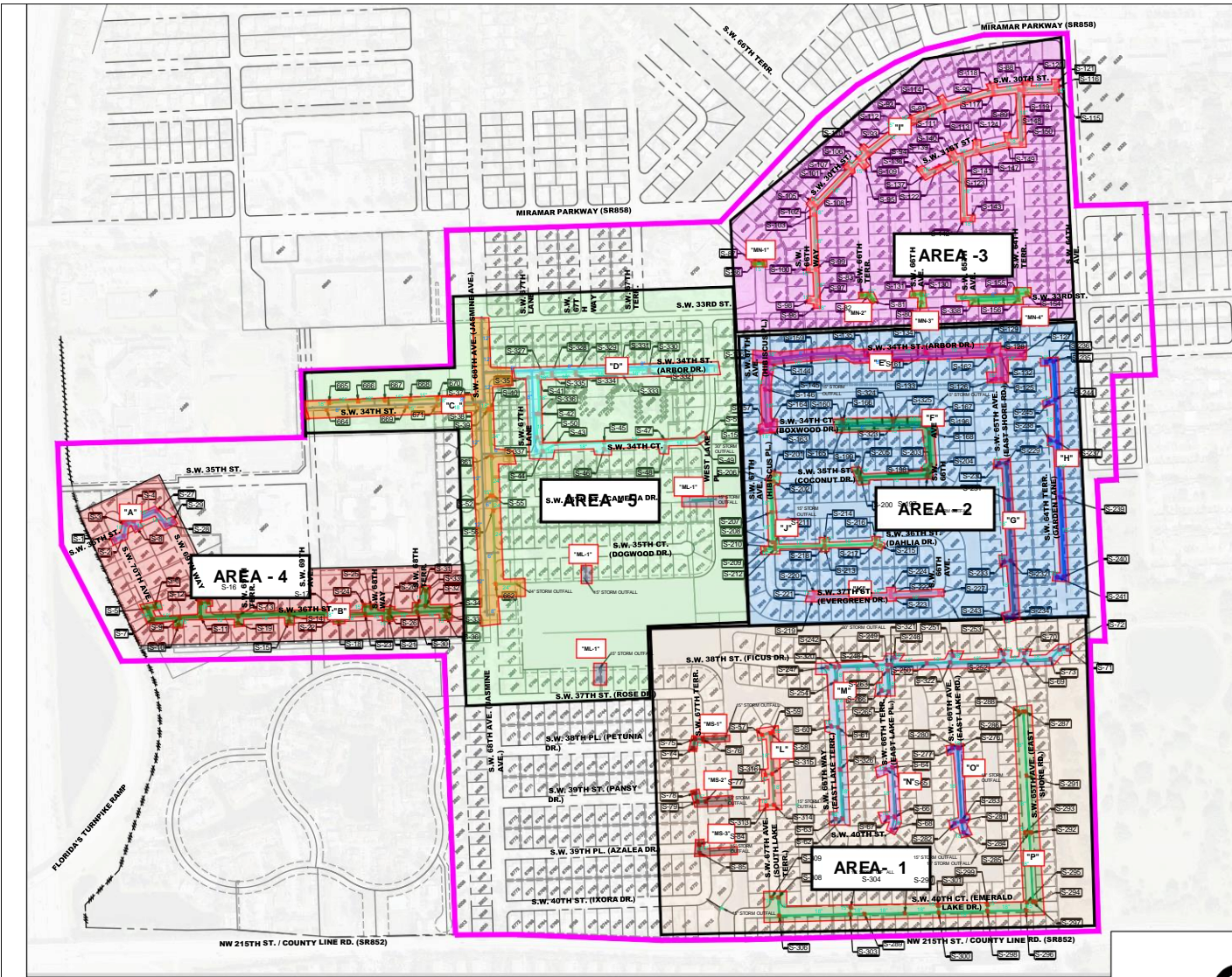

LEGEND

- PROPOSED STORM STRUCTURE
- PROPOSED STORM PIPE
- S-100 PROPOSED STORM STRUCTURE LABEL
- PROPOSED WATER PIPE
- HMDI-IV BOUNDARY

Kevinb
2022-09-24 15:46:34

-ZONE - 1

Area sequencing for underground utility piping installation.

HISTORIC MIRAMAR DRAINAGE IMPROVEMENT PROJECT PHASE IV



Craven • Thompson and Associates, Inc.
 ENGINEERS • PLANNERS • SURVEYORS
 3563 N.W. 53RD STREET, FORT LAUDERDALE, FLORIDA 33309
 FAX: (954) 739-6409 TEL.: (954) 739-6400
 FLORIDA LICENSED ENGINEERING, SURVEYING & MAPPING BUSINESS No. 271
 FLORIDA LICENSED LANDSCAPE ARCHITECTURE BUSINESS No. C000114

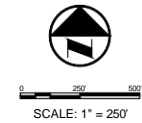
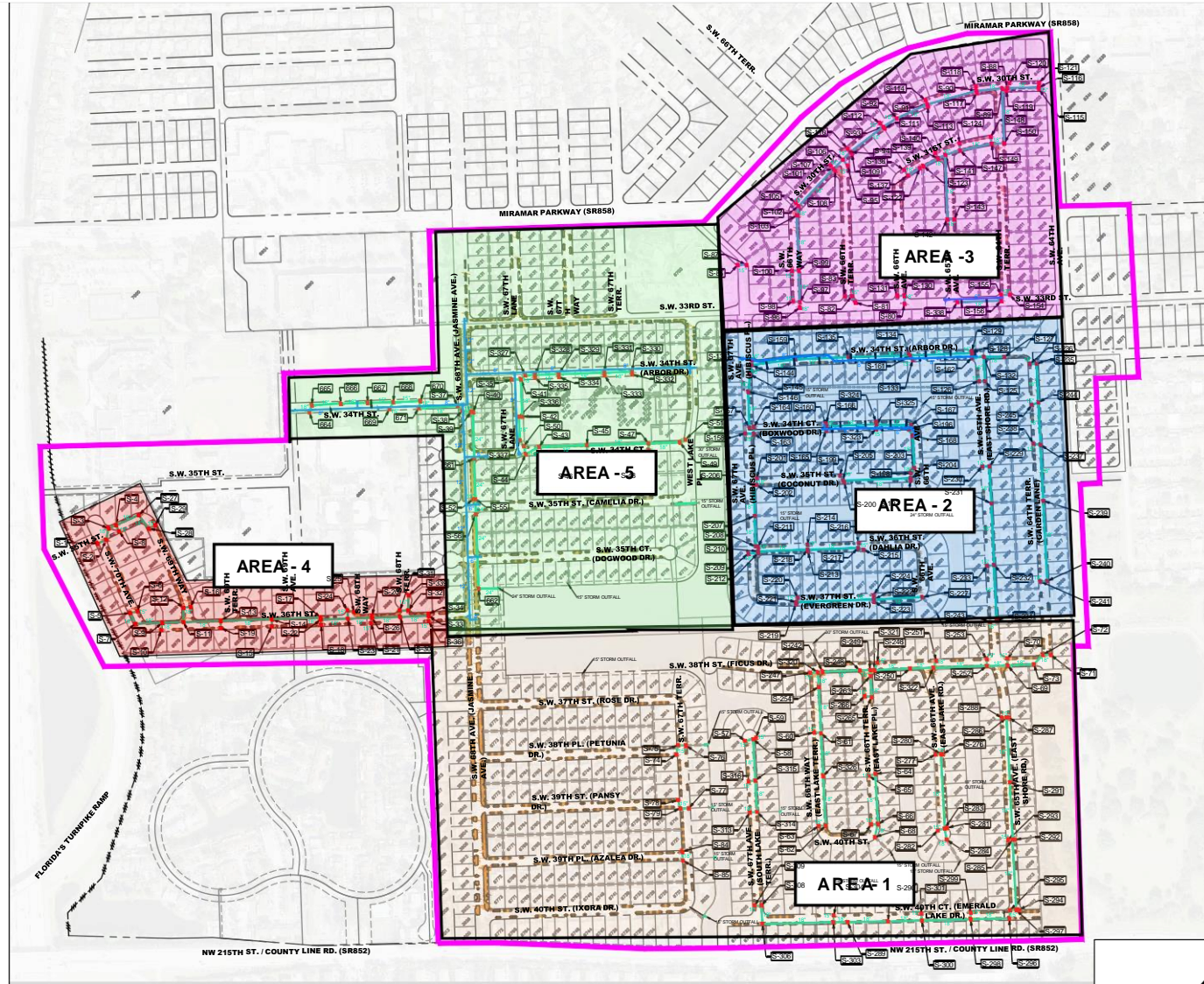

LEGEND

- PROPOSED STORM STRUCTURE
- PROPOSED STORM PIPE
- S-XXX PROPOSED STORM STRUCTURE LABEL
- PROPOSED WATER PIPE
- HMDI-IV BOUNDARY
- SWALE RESTORATION

Area sequencing for swale and drainage restoration.

HISTORIC MIRAMAR DRAINAGE IMPROVEMENT PROJECT PHASE IV

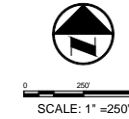
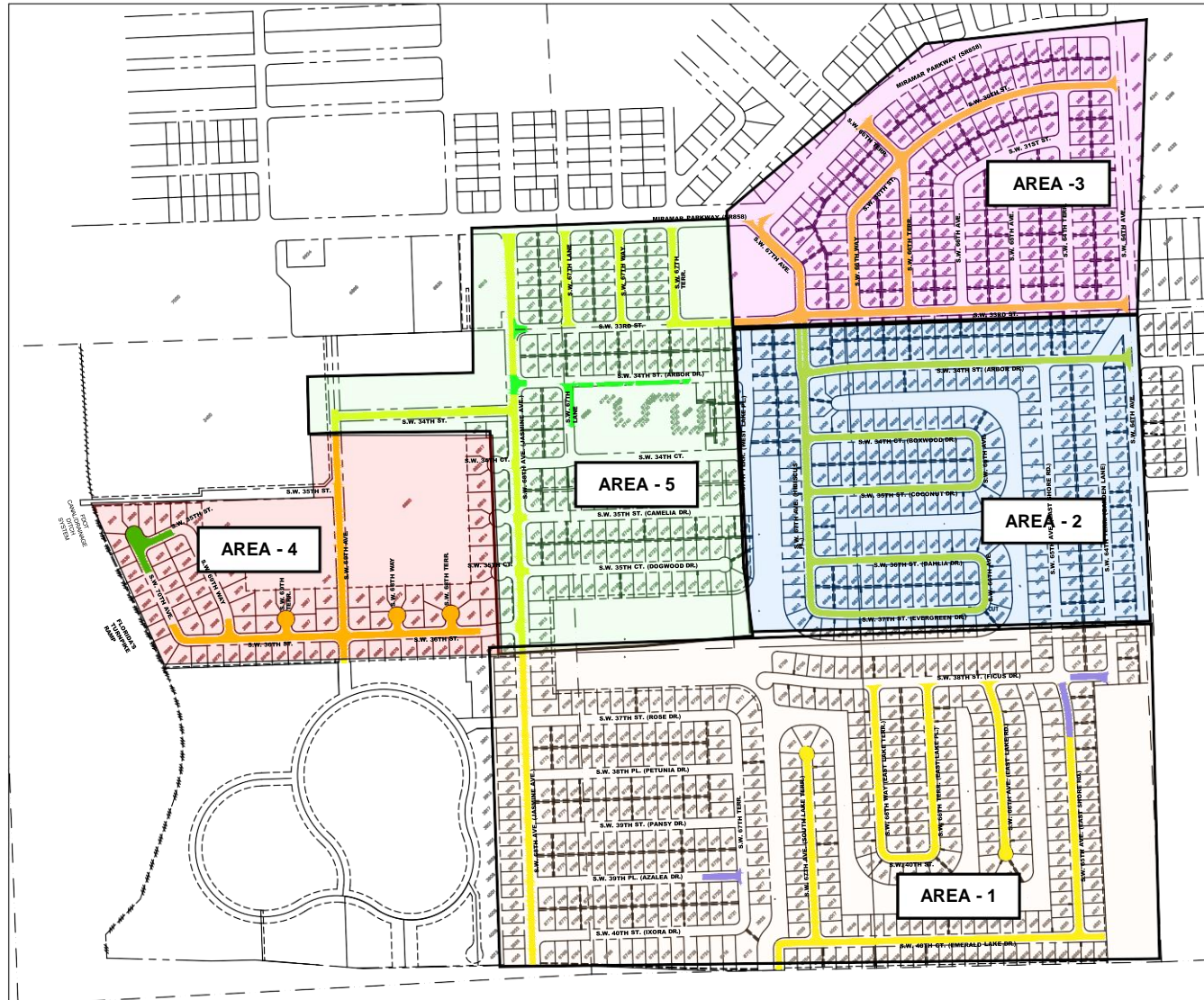

SCALE: 1" = 250'

LEGEND

- MILL & OVERLAY
- PERVIOUS PAVEMENT
- ROADWAY RECONSTRUCTION

Area sequencing
for roadway
restoration.

HISTORIC MIRAMAR DRAINAGE IMPROVEMENT PROJECT PHASE IV ROAD OVERLAY & RECONSTRUCTION PLAN



Craven • Thompson and Associates, Inc.
 ENGINEERS • PLANNERS • SURVEYORS
 3563 N.W. 53RD STREET, FORT LAUDERDALE, FLORIDA 33309
 FAX: (954) 739-6409 TEL: (954) 739-6400
 FLORIDA LICENSED ENGINEERING, SURVEYING & MAPPING BUSINESS No. 271
 FLORIDA LICENSED LANDSCAPE ARCHITECTURE BUSINESS No. C000114

ZERO TAIL EXCAVATORS

Mancon currently owns a fleet of “zero tail” excavators. This allows local traffic to be flagged safely around machinery while in operation.



Storm Sewer, Watermain and Water Service Installation Process

GROUND PENETRATING RADAR

The pink paint is placed adjacent to utility owners' color coded marks. This is our way of confirming existing utilities to prevent utility strikes and damage to existing utilities, especially high profile fiber optic cables, thus reducing the risk of weeks of service interruption to residents and businesses.



Storm Sewer, Watermain and Water Service Installation Process

POT HOLING

This is always done before the main line-crew is near; especially high profile fiber optic cables and FPL power cables.



Storm Sewer, Watermain and Water Service Installation Process

Finish Grade Road Rock and Asphalt Trench Patch Restoration

Typical snapshot of the installation and restoration operation.

- Pipe crew installing storm sewer and water main.
- Road crew backfilling the trench, compacting in lifts, and placing / compacting road rock.
- This will provide a temporary driving surface until the asphalt patch paving begins.



Storm Sewer, Watermain and Water Service Installation Process

Finish Grade Road Rock and Asphalt Trench Patch Restoration

This is a snapshot of straight, neat, and clean work zone while installing 8-inch water main and water services. This is the temporary driving surface. Trench is ready for an asphalt patch.

- .



Storm Sewer, Watermain and Water Service Installation Process

Asphalt Trench Patch

No pavement penetrations were made for water services and water service casings. Hot asphalt patch performed bi-monthly at a minimum.



Storm Sewer, Watermain and Water Service Installation Process

- Dickey Consulting Services (DCS) will be the point of contact for residents, businesses and property owners.
- DCS will maintain a concerns log with issues/concerns for resolution by the project team from property owners with their contact information and will respond within 24 hours.
- Hotline number is 877-891-0652 and e-mail: info@dickeyinc.com.

Public Outreach Contact