



Miramar | Building Division

Community & Economic Development Department
 2200 Civic Center Place | Miramar, Florida 33025
 Tel: 954.602.3200 | Fax: 954.602.3635
 www.miramarfl.gov

Footing Detail for Residential Patio Slab & Storage Shed Slab

- The area under proposed conc. slabs shall be free of debris and other deleterious materials.

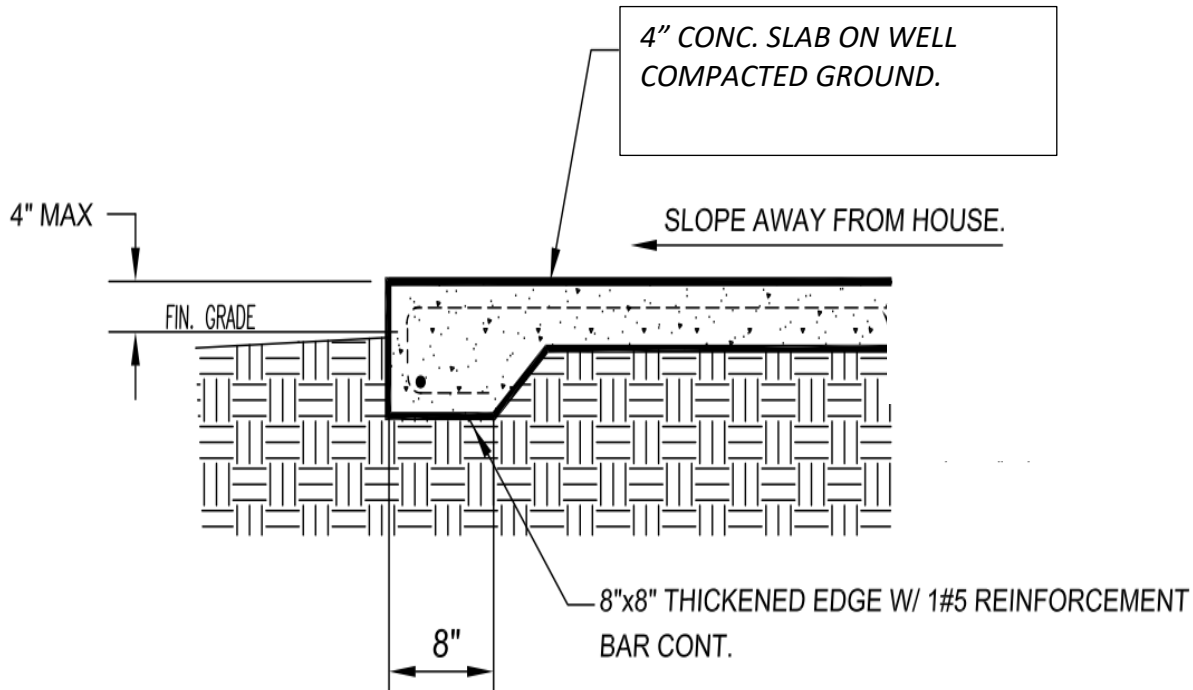

ALTERNATE OPTION FOR SLAB REINFORCEMENT:

- Welded Wire Mesh: Applicant shall state clearly on plans and on the application (Description of work) the use of Wire Mesh as reinforcement.
- Synthetic Reinforcing Fiber: Provide manufacturer's specifications indicating fiber dosage per cubic yard of concrete and compliance with ASTM C1116. Applicant shall state clearly on the application and plans the use of reinforcing fiber as reinforcement.

NOTE:

- For Residential Concrete Driveway, a thickened edge is optional.
- For Commercial Conc. Slab: Engineered details signed & sealed by Prof. Engineer are required, indicating reinforcement and dimensions.

REQUIRED PLANS REVIEW

RESIDENTIAL	COMMERCIAL
PLANNING & ZONING	PLANNING & ZONING
BUILDING/STRUCTURAL	FIRE DEPT.
	BUILDING/STRUCTURAL

REQUIRED INSPECTIONS

RESIDENTIAL	COMMERCIAL
Foundation B111 (Prior to Pour concrete)	Foundation B111 (Prior to Pour concrete)
Final Inspection B-999	Fire Marshal B-801. (When work is Completed)
	Foundation – B111 (After Fire Marshal Approval)

FOR FINAL INSPECTION, THE WORK AREASHALL BE CLEAN OF DEBRIS AND/OR REMAINING CONSTRUCTION MATERIALS